

## MODULAR HOUSE TRANSPORT INSTRUCTION

The client/distributor/user is required to familiarize themselves with these guidelines prior to transporting and assembling the modular home. | 1

- The residential modules are manufactured in a production hall and finished internally and externally according to the order's specifications. The completed module is transported on a low-loader trailer to the construction site.
- The trailer dimensions must match the module's weight and external dimensions.
- To arrange transportation, provide the transport company with:
  - The total external dimensions of the module, including any elements sticking out beyond the facade and roof during transport (e.g., external lighting, air conditioning units, gutters, downpipes, etc.).
  - The module's weight.
  - The width to which the trailer must extend during transport.
  - The pickup location and precise delivery address (a Google Maps pin is recommended).
- During transport, the longitudinal walls of the module (marked red below) must be supported. The trailer should be able to extend to the width of the outer faces of the longitudinal walls.

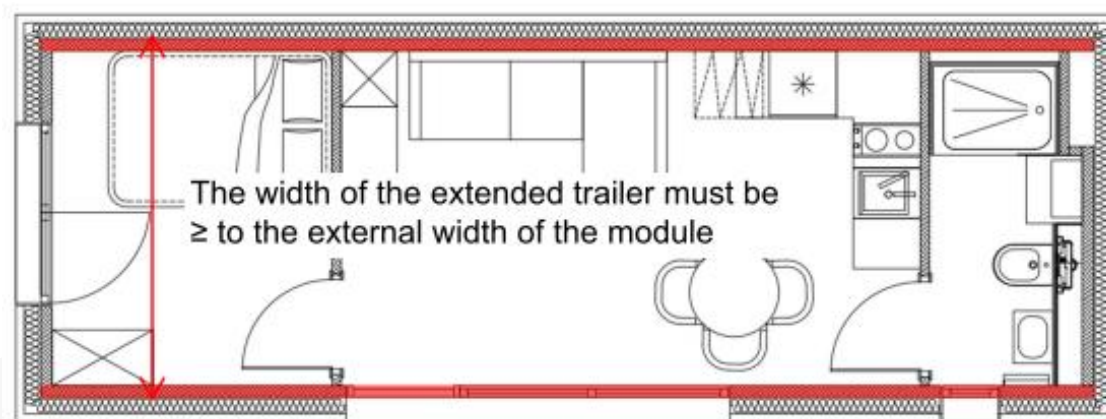

- If this is not possible, wooden beams must be placed on the trailer to support the longitudinal walls as shown in the diagram below. Beam spacing should be approximately 1 meter. The length of the beams must be at least the width of the external faces of the longitudinal walls plus 20 cm.

Other transportation methods are not permitted.

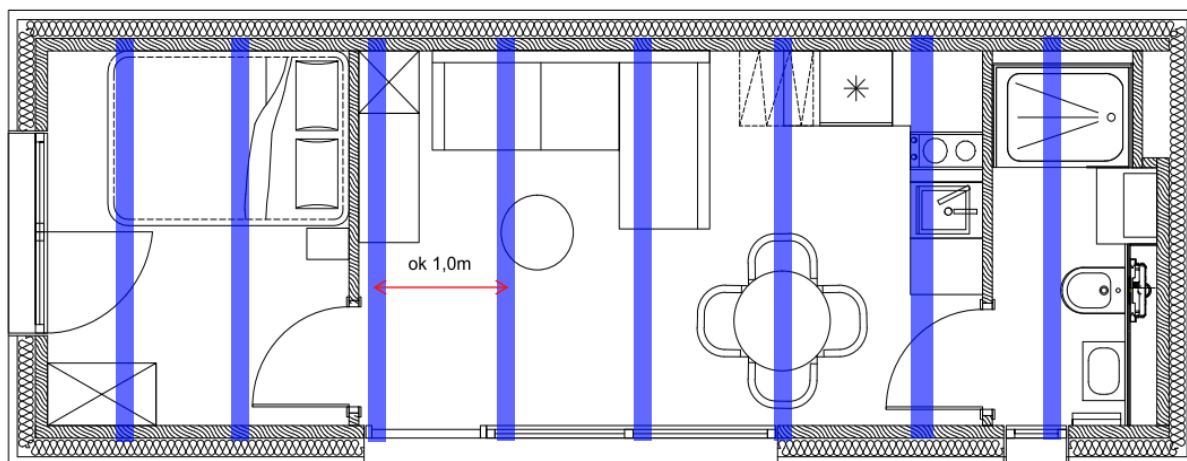

- The module must be secured against uncontrolled movement during braking.
- Modules without external facades and roofs can be strapped to the trailer as shown in the image below.



- A module with a completed facade and roof cannot be strapped with transport belts around it. It must be secured to the trailer using transport belts attached to transport brackets mounted on the lower plane of the longitudinal walls.



Fig. Example of brackets for securing the module to the trailer.



- The module for transport is wrapped in protective foil. The foil must not be damaged during the transportation of the module.