

Smart Photoelectric Smoke Sensor User Manual

M414-6Ever1.1

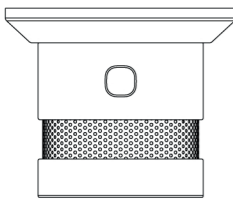

*Please read the user manual carefully before operation. The guide picture is for reference only. Please in kind prevail.

This product is a smart photoelectric smoke sensor, with ultra-low-power ZigBee wireless network technology design. It is capable of real-time detecting the presence of smoke, once detect danger of fire smoke, red LED flashes rapidly and detectors sound alarm once detecting smoke fire danger, can alert you and your family timely. It can be widely used in household, lounge, coffee house, dancing hall any other places need fire alarm monitoring. Free tool installation, once stick once use.

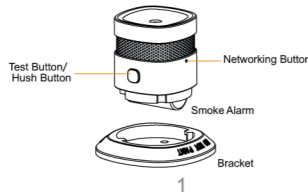

Product Introduction

Technical Specification

1. Operating Voltage: DC3V (CR123A lithium battery)
2. Static Current: $\leq 10\mu A$
3. Alarm Current: $\leq 60mA$
4. Alarm Indication: Red LED
5. Sound Level: $\geq 80dB/3m$
6. Networking Way: ZigBee Ad-Hoc Networking
7. Distance Of Ad-Hoc Network: $\geq 70m$ (open area)
8. Working Temperature: $-10^{\circ}C \sim +50^{\circ}C$
9. Working Humidity: $\leq 95\%RH$
10. Dimension: $60 \times 60 \times 49.2mm$

- **Flat ceiling mounting**
The preferred location to install smoke sensor is in the centre of the ceiling, because smoke, heat and combustible products rise to ceiling and will laterally spread. Keep at least 30cm distance from lights or decorations, and at least 15 cm away from walls and corners.

- **Sloping ceiling mounting**
If ceiling is sloping, please install the smoke sensor at horizontal distance 90cm away from the ceiling top.



Recommended and Avoided Installation Position

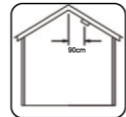

Sloping Ceiling Mounting Position

Installation

- Pls put smart hub into the center of alarm.
- Pls shorten the distance between smart hub and alarm.
- Pls reduce barriers between smart hub and alarms.
- Avoid installing in places with high noise area or high frequency interference, like places near from metal air conditioner, heater devices, current circuit breaker control box.
- Building materials with metal net or metal bar may reduce the wireless transmission distance, like reinforced concrete wall.
- Damping of the signal makes direct ratio with barrier, if the materials of the barrier is homogeneous.

Installation Guide

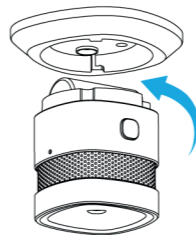

- Anticlockwise rotating the bracket out from the installation base.



Installation one

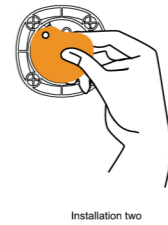

Installation two

- Installation one: fixed the bracket into ceiling using screws.
- Installation two: remove the double-sided adhesive and stick alarm into ceiling.

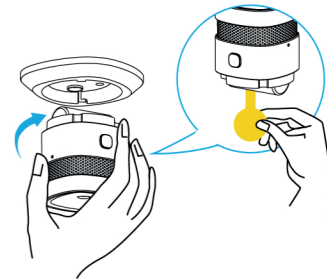

- Remove the battery insulating strip to make detector on power, and clockwise rotating alarm into bracket.



- Click "+" on the APP interface, and enter the networking mode. (Pls take user manual of smart hub for reference)

Networking

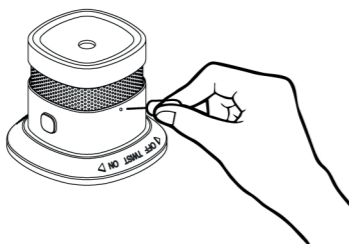

- Adding network: according to APP prompt, press the button for 2 seconds after the networking equipment, green flash, APP interface prompted, networking success.
- Disconnect network: press the networking button for 5 seconds to disconnect the network, after the green light flashes slowly for 3 seconds, which indicates network is disconnected successfully.

LED State and Alarm

| State | LED | Sound Alarm |
|-----------|--------------------------------------|------------------------------------|
| Standby | red LED flash every 53 seconds | NO |
| Test | red LED flash quickly | rapid "Di-Di-Di" |
| Alarm | red LED flash quickly | rapid "Di-Di-Di" |
| Hush | red LED flash every 10 seconds | NO |
| Low Power | red LED flash one time | "Di" every 53 seconds |
| Fault | red LED flash twice every 53 seconds | "Di-Di" for twice every 53 seconds |

From 1

| LED | State |
|-------|--|
| Green | 1. Rapidly flash during networking (5 times/second) 2. Keep on for around 3 seconds if network success 3. Flash slowly if network failed (twice/second) six times |
| Red | 1. APP operation, ZigBee network failed, flash slowly 6 times 2. long press network button for 5 seconds, red LED on around 2 seconds, then flash slowly for 6 times, disconnect success. |

FAQ

| Phenomenon | Analysis | Treatment |
|------------------------------------|---|--|
| Power on and alarm | there is large dust or vapour | power on after cleaning dust or vapour |
| Power on with short "Di-Di" | Low power | Change same battery |
| Buzzer do not alarm or small sound | Low power | Change same battery |
| Press test button but no alarm | power connect of battery, or battery polarity inverse | install battery and pay attention to battery polarity |
| | Low power | Change same battery |
| | Low power | Change same battery |
| Device off line | smart device too far away from smart hub | 1. Add repeater 2. Shorten distance between smart hub and smart devices, press test button or power on again. |
| | Alarm device not quit from network | Quit network first before networking |
| Networking failed | gateway do not enter network state | Make sure gateway under networking state |

Please make sure that there is no real danger of fire when using mute function. Under known and non-fire alarm condition, please do not block or by any other form to prohibit alarming. Press the Test/Mute button to lower sensitivity and relieve alarm.



Press and hold the test panel Test/Mute button for 3 seconds, as above picture shows, until alarm status (see status table). Testing is recommended to be done at least once a week. Do not use flame for testing. Once the alarm is sure to please pay attention.

Hush and Test

Battery Replacement

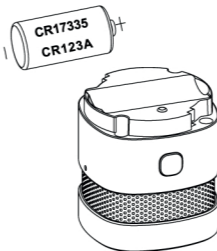

- Please replace battery correctly, following the battery positive and negative electrode. Attention to environmental protection and dispose used battery properly.

1. Pls press test button to test alarm devices weekly, after devices put into use. Pls inspect the alarm device or return back factory if any faults happened (like buzzer do not make sound, LED do not turn on).
2. Battery can use around 3 years under normal condition, high temperature, high humidity or other poor condition may shorten battery life span.
3. Pls change the same battery timely when receiving low power indication, press test button if alarm device make sound and flash alarm means change battery success.
4. Pls install alarm device as soon as alarm devices planning to be test, make sure alarm devices in good condition, and takes measure for dust proof, damp proof and corrosion proof etc.
5. Do not dismantle alarm devices privately if any problems of alarm devices happened, pls power off and contact local agent.
6. Suggest change new battery after real fire alarm happened.

Maintenance

Warning

1. Do not install alarm devices in places with high temperature, high humidity, heavy oil fume, and keep nearby environment clean.
2. Avoid install in places near from heavy oil paint, diluent or other colloid suspended solids, in case of any influence for normal detecting of alarm devices.
3. This product is household usage smart smoke alarm, which can make sound and flash alarm when fire happens, but can not put out a fire.

Announcement

*The guide picture is for reference only. Please in kind prevail.
*Factory has final right for explanation if there is any inconformity between practical use and user instruction, as technology is improving form time to time.